

TKS

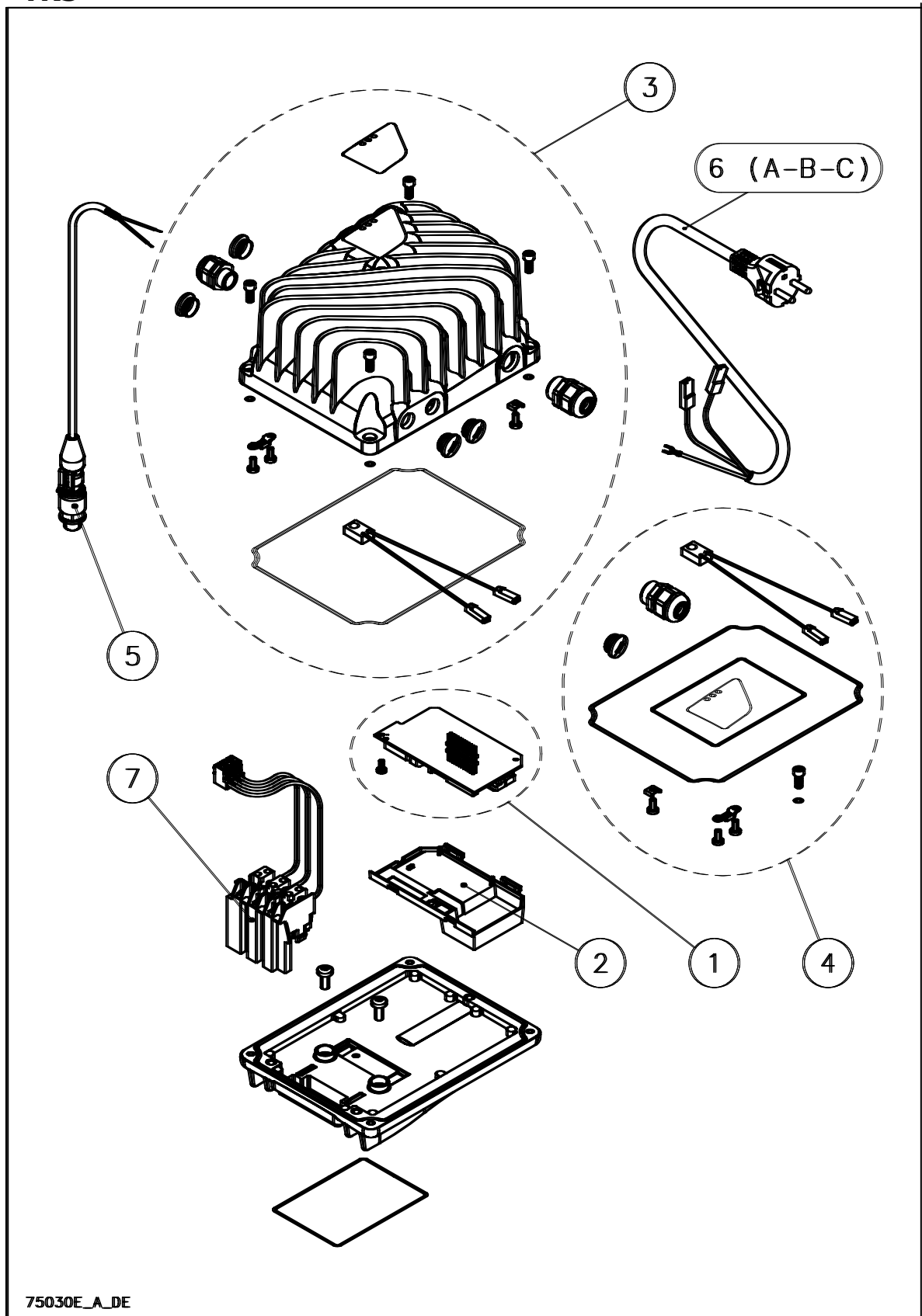

75030E_A_DE

TKS_June11_EdA.xls

SPARE PARTS LIST AVAILABLE

KIT	DESCRIPTION	CODE
1	CONTROL CARD	KR7600000
1A	CONTROL CARD TKS/4HM9	KR7600100
2	CONTROL CARD PLASTIC COVER	KR7600010
3	POWER MODULE	KR7600020
4	DRIVE FITTINGS (ACCESSORIES) BAG	KR7600030
5	PRESSURE TRANSMITTER WITH CABLE	KR7600040
6A	CABLE WITH PLUG UE	KR7600050
6B	CABLE WITH PLUG GB	KR7600060
6C	CABLE WITH PLUG AU	KR7600070
7	TERMINAL PLUG-IN WITH CABLES	KR7600080
8	COMPLETE POWER DRIVE (1 + 2+ 3 + 6 - no plug)	KR7600090
8A	COMPLETE POWER DRIVE TKS/4HM9 (1A + 2+ 3 + 6 - no plug)	KR7600110

TKS Unit has Control card with CPU Unit having new Square shape since june 2009

ELECTRICAL PUMPS OF REFERENCE

PUMP TYPE	UE PLUG	GB PLUG	AU PLUG	PUMP TYPE	UE PLUG	GB PLUG	AU PLUG
TKS/HMZ				TKS/CEA-CA			
TKS/2HM3ZT	107600130	107600135	107600136	TKS/CEA80/5	107600420	107600425	107600426
TKS/2HM5ZT	107600150	107600155	107600156	TKS/CEA120/5	107600440	107600445	107600446
TKS/2HM7ZT	107600160	107600165	107600166	TKS/CA70/33	107600700	107600705	107600706
TKS/4HM4ZT	107600170	107600175	107600176	TKS/CA70/44	107600720	107600725	107600726
TKS/4HM5ZT	107600180	107600185	107600186				
TKS/4HM9ZT	107600200	107600205	107600206				
TKS/BG				TKS/SV			
TKS/BG7	107600320	107600325	107600326	TKS/SV206F07T	107602041	107602045	107602046
TKS/BG11	107600340	107600345	107600346	TKS/SV208F11T	107602061	107602065	107602066
				TKS/SV404F07T	107602171	107602175	107602176
				TKS/SV407F11T	107602201	107602205	107602206

ELECTRICAL PUMPS WITH Motor IE2 Efficiency Standard

Motor ---> Frame ---> kW --->	SM IE2				Code range
	63	71	80	80	
	0,40	0,55	0,75	1,10	
TKS/ 1-22SV (F/N -T-R)	X	X	X	X	107607011 / 7461
TKS/ HM - HMS			X	X	104420160 / 0285
TKS/ BG			X	X	104420320 / 0346
TKS/ CEA - CEAN			X	X	104420420 / 0460
TKS/CA			X	X	104420800 / 0816
TKS/CO			X		104420870
TKS/SVI-E			X		104421800
TKS/SVI-S				X	104421300
TKS/SM80			X	X	104429800/9801

For spare parts concerning motor and hydraulic please refer to standard electropumps spare part cards.
I.e. TKS/BG7 UE PLUG part number 107600320 is referred to BG7/A part number 107320080.