

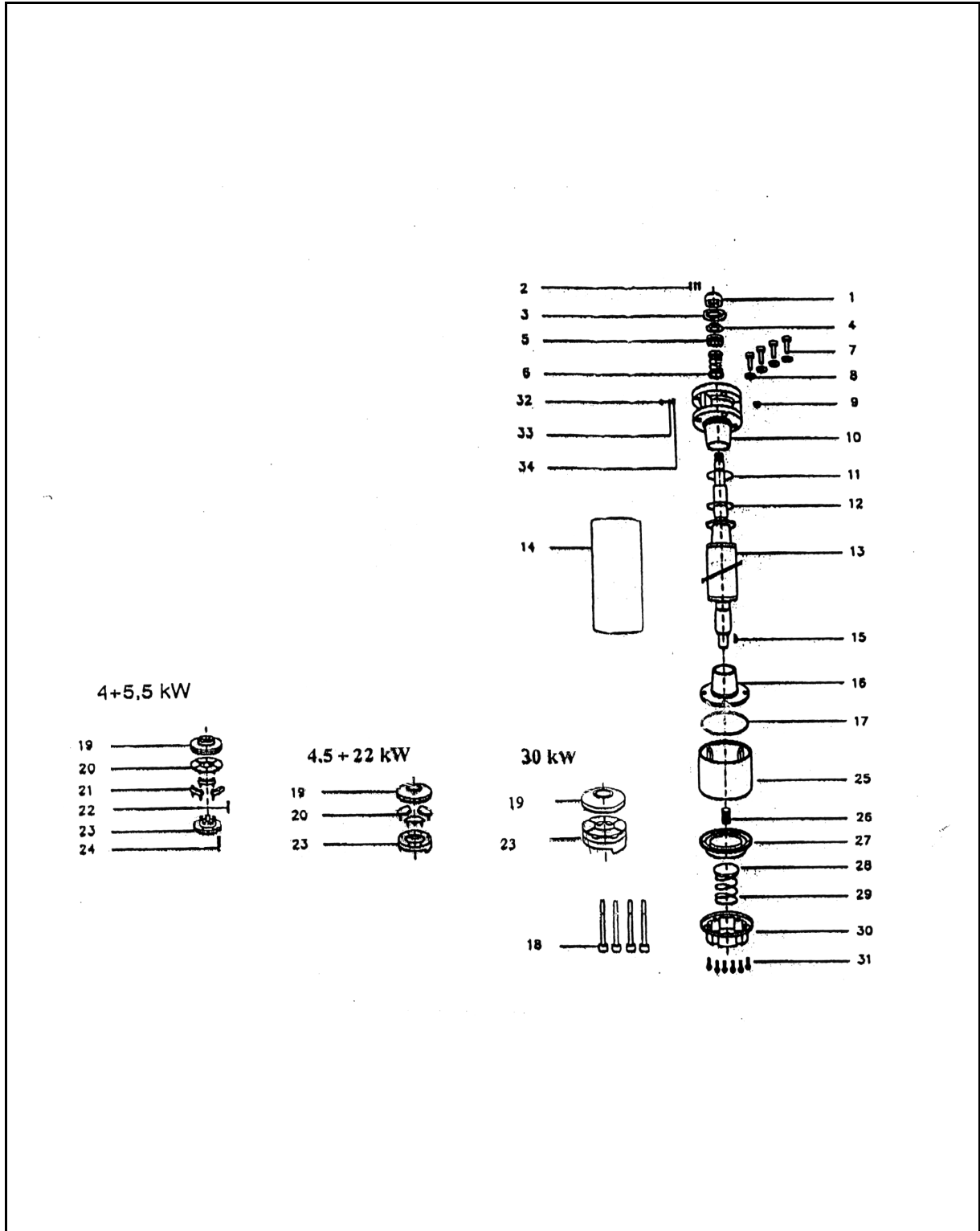

Motore Sommerso 6" Serie F6 (3~, 50Hz, 4 - 30 kW)
F6 Submersible Motor 6" Series (3~, 50Hz, 4 - 30 kW)



N.Rif. Item N.	Descrizione	Description	Q.ta Q.ty	Codice - Code											
				F605T534	F607T534	F610T534	F612T534	F615T534	F620T534	F625T534	F630T534	F640T534	F650T534	F660T534	
				107047003	107047013	107047023	107047033	107047043	107047053	107047063	107047073	107047083	107047093	107047103	
				4 kW (5HP)	5,5 kW (7HP)	7,5 kW (10HP)	9,2 kW (12HP)	11 kW (15HP)	15 kW (20HP)	18,5 kW (25HP)	22 kW (30HP)	30 kW (40HP)	37 kW (50HP)	45 kW (60HP)	
* 1	Anello di tenuta	Slinger	1	KIT C											
2	Vite del coperchio	Screw, seal	3	KIT C											
3	Coperchio, guarnizione	Cover, seal	1	KIT C											
4	Disco di tenuta	Bushing seal cover	1	KIT C											
* 5	Tenuta mecc. parte fissa	Seal, stationary part	1	KIT B											
* 6	Tenuta mecc. parte rotante	Seal, rotating part	1	KIT B											
7	Vite	Screw	4	KIT D											
8	Rondella elastica	Lockwasher	4	KIT D											
9	Filtro	Filter	1	187040690											
10	Flangia superiore	Top Endbell	1	187040700											
* 11	OR	OR	1	KIT B											
12	Disco reggispinta	Upthrust washer	1	18704-071-0											
13	Albero con rotore	Rotor assembly	1	187040720	187040730	187040740	O/R	187040750	187040760	187040770	187040780	187040790	O/R	O/R	
14	Pacco statore (380/415 V)	Stator assembly (380/415 V)	1	187040800	187040810	187040820	O/R	187040830	187040840	187040850	187040860	187040870	O/R	O/R	
15	Linguetta a disco	Woodruff key	1	187040880											
16	Flangia inferiore	End bell, Lower	1	187040885											
* 17	OR	OR	1	187040890											
18	Vite, allogg. cusc. reggispinta	Screw, thrust housing	4	KIT B											
19	Cuscinetto reggispinta	Thrust disc, assy	1	KIT D											
20	Pattini oscillanti	Segment, assy	6	KIT A1											
21	Leva oscillante	Rocker arm	3	KIT A2											
22	Perno della leva oscillante	Pin, rocker arm	6	KIT A3											
23	Bilancere	Adapter sleeve	1	187040900											
24	Perno	Pin	1	187040910											
25	Allogg. cusc. reggispinta	Thrust housing	1	187040920											
26	Perno a vite	Screw adjusting	1	187040930											
27	Diaframma	Diaphragm	1	187040940											
28	Disco diaframma (sulla molla)	Cup spring, diaphragm	1	187040950											
29	Molla	Spring	1	187040960											
30	Fondello	Cover, diaphragm	1	187040970											
31	Vite fondello	Screw, cover, diaphragm	6	187040980											
32	Vite di terra	Screw, ground	1	187040990											
33	Rondella elastica	Lockwasher, ground	1	187041000											
34	Serra-filo	Square washer	1	187041010											

* Parti di ricambio consigliate - Recommended spare parts
O/R = A Richiesta, On Request

KITS	Description	Part Name	Posizione - Position	Codice - Code
A1	Reggispinta	Thrust bearing	19 + 20	187041020
A2	Reggispinta	Thrust bearing	19 + 20	187041030
A3	Reggispinta	Thrust bearing	19 + 20	187041031
B	Guarnizioni / Tenute(fino a 1993)	Seals (up to 1993)	5 + 6 + 11 + 17 + 27	187041040
B1	Guarnizioni / Tenute (da 1994)	Seals (since 1994)	5 + 6 + 11 + 17 + 27	187041041
C	Anelli di tenuta	Slinger	1 + 2 + 3 + 4	187041050
D	Kit viteria	Screws Kit	7 + 8 + 18 + 31	187041060