

VALIDO SOLO PER
VERSIONI SPECIALI

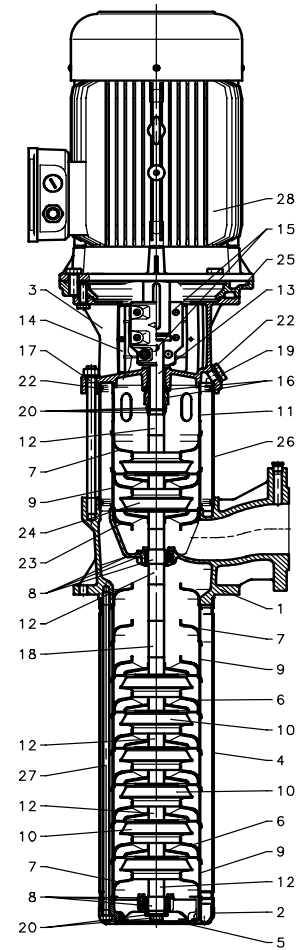

VALIDO SOLO PER
VERSIONI SPECIALI

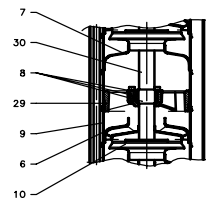
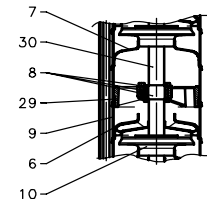

LEGEND FOR WRITTEN : VALID ONLY FOR SPECIAL VERSIONS

ITEM N	DESCRIZIONE	DESCRIPTION	Q.TA/ Q.TY	CODICE - CODE															
				SVI3001/08N	SVI3002/08N	SVI3003/08N	SVI3004/08N	SVI3005/08N	-	-	-	-	-	-					
				10244401H	10244402H	10244403H	10244404H	10244405H	-	-	-	-	-	-					
				SVI3001/11N	SVI3002/11N	SVI3003/11N	SVI3004/11N	SVI3005/11N	SVI3006/13N	SVI3007/13N	SVI3008/13N	SVI3009/13N	SVI3010/13N	SVI3011/14N	SVI3012/15N				
				10244401L	10244402L	10244403L	10244404L	10244405L	10244406N	10244407N	10244408N	10244409N	10244410N	10244411P	10244412Q				
				SVI3001/14N	SVI3002/14N	SVI3003/14N	SVI3004/14N	SVI3005/14N	-	-	-	-	-	-	-				
				10244401P	10244402P	10244403P	10244404P	10244405P	-	-	-	-	-	-	-				
				3 kW	4 kW	5.5 kW	7.5 kW	11 kW	-	-	15 kW	-	18.5 kW	-	22 kW				
1	Bocca di mandata	Delivery outlet	1	151402650			151402660			151402680									
2	Fondello di aspirazione	Suction bottom cover	1	161408140															
3	Lanterna	Adaptor	1	-						161452811									
4	Camicia inferiore - 8 stadi	Lower sleeve - 8 stages	=>	1-166441340						-									
	Camicia inferiore - 11 stadi	Lower sleeve - 11 stages	=>	1-166441370															
	Camicia inferiore - 14 stadi	Lower sleeve - 14 stages	=>	2-166441390 (anello unione 168601640 non incl., connecting ring 168601640 not incl.)															
5	Filtro	Strainer	1	164600730															
* 6	Diffusore destro	Right diffuser	=>	152801220															
7	Coperchio diffusore	Diffuser cover	=>	1	2	3	4	5	4	5	6	7	8						
				Q2 - 164001730						Q3 - 164001730									
8	Kit cuscinetto	Bearing kit	=>	148992210															
	N-B 8-11-14 stadi	N-B 8-11-14 stages	=>	2/2/3															
	B	B	=>	-															
9	Distanziale diffusori	Diffuser spacer	Q	162502310															
* 10	Girante destra	Right impeller	R	150702240															
11	Distanziale finale	Final spacer	1	1	2	3	4	5	4	5	6	7	8						
	Distanziale girante	Impeller spacer	=>	162502290															
12				162502430															
				1	2	3	4	5	9	10	11	12	13	14	15				
13	Albero N-B 8-11-14 stadi	Shaft N-B 8-11-14 stages	1	165042760/165042770/165042775															
	Albero B	Shaft B		-															
14	Protezione giunto	Coupling guard	2	164206580			164206590						165042730			165042740		165042750	
15	Kit semigiunti	Pair of couplings kit	1	148992390			148992400			148992410						148992420			
* 16	Tenuta meccanica	Mechanical seal	1	002232570															
31	Disco portatenuta	Seal holding disc	1	150101590															
17	Tirante	Tie rod	4	-						167103480			167103490		167103500				
	Dado M16	Nut M16		002617888															
18	Distanziale sostit. girante	Spacer replacing impeller	Q1	162502460															
19	Tappo carico (+ OR)	Fill plug (+ OR)	1	140170250															
* 20	Kit blocc. pacco giranti	Fixing impeller pack kit	1	148992160															
* 22	OR	OR	- 2	-															
* 23	Diffusore sinistro	Left diffuser	=>	-						002221691			152801230						
* 24	Girante sinistra	Left impeller	L	-															
				-						2			150702250			3		4	
25	Flangia per raccordo	Flange for connection	1	-						161050590									
26	Camicia superiore	Higher sleeve	1	-						166406920			166406930			166406940			
27	Tirante + dado M12	Tie rod + nut M12	4 + 4	167103430 + 002630710															
				167103460 + 002630710															
				167103470 + 002630710															
28	Motore trifase (T)	Three phase motor (T)	1	107106255	107106329	107106337	107106347	107106397	107106421			107106431			107106447				
	Tipo	Type		LM100RB14/330	LM112RB14S1/340	LM132RB5/355	LM132RB5/375	LM160RB5/3110	LM160B5/3150			LM160B5/3185			LM180RB5/3220				
** 29	Supporto boccola sald.	Bushing support	=>	151402690															
	N-B 8-11-14 stadi	N-B 8-11-14 stages	=>	1/1/2															
	B	B	=>	-															
** 30	Distanziale per supp. spec.	Spacer for special support	=>	162502760															
	N-B 8-11-14 stadi	N-B 8-11-14 stages	=>	2/2/3															
	B	B	=>	-															

* Parti di ricambio consigliate - Recommended spare parts

Q = N. stadi / stages
 Q1 = Q - (L+R) - 2 ; Per N-B / For N-B => 14 stadi/stages, Q1 = Q - (L+R) - 4
 Q2 = Q - (L+R) ; Per N-B / For N-B => 14 stadi/stages, Q1 = Q - (L+R) - 1
 Q3 = Q - (L+R) + 1, Per B / For B

** Solo Versioni Speciali - Only Special Versions:
 B = Bilanciate / Balanced , N - B = Non Bilanciate / Not Balanced