

VALIDO SOLO PER
VERSIONI SPECIALI

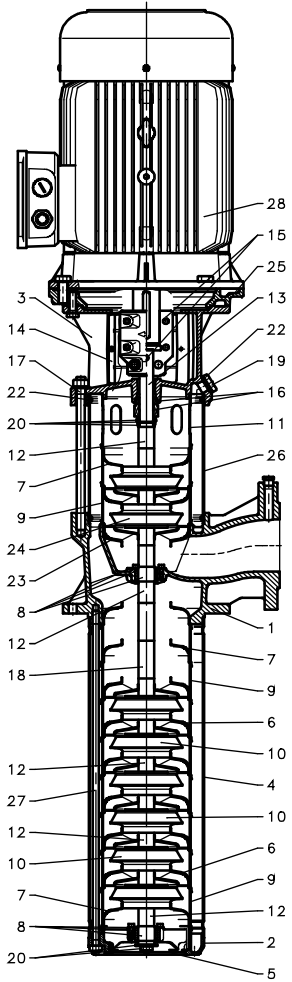

VALIDO SOLO PER
VERSIONI SPECIALI

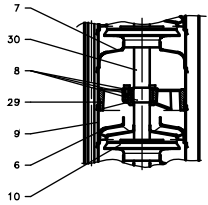
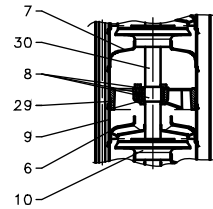

LEGEND FOR WRITTEN : VALID ONLY FOR SPECIAL VERSIONS

ITEM N	DESCRIZIONE	DESCRIPTION	Q.TA' Q.TY	SVI 60S/P											
				SVI6001/08S	SVI6002/08S	SVI6003/08S	SVI6004/08S	SVI6005/08S	-	-	-				
				10170221H	10170222H	10170223H	10170224H	10170225H	-	-	-				
				SVI6001/11S	SVI6002/11S	SVI6003/11S	SVI6004/11S	SVI6005/11S	SVI6006/13S	SVI6007/13S	SVI6008/13S				
				10170221L	10170222L	10170223L	10170224L	10170225L	10170226N	10170227N	10170228N				
				SVI6001/14S	SVI6002/14S	SVI6003/14S	SVI6004/14S	SVI6005/14S	SVI6006/16S	SVI6007/16S	SVI6008/16S				
				10170221P	10170222P	10170223P	10170224P	10170225P	10170226R	10170227R	10170228R				
				3 kW	5,5 kW	7,5 kW	11 kW	15 kW	18,5 kW	22 kW					
1	Bocca di mandata	Delivery outlet	1	151450500	151450510				151450530						
2	Fondello di aspirazione	Suction bottom cover	1	161408140											
3	Lanterna	Adaptor	1									161452801			
4	Camicia inferiore - 8 stadi	Lower sleeve - 8 stages	=>	1-166441340											
	Camicia inferiore - 11 stadi	Lower sleeve - 11 stages	=>					1-166441370							
	Camicia inferiore - 14 stadi	Lower sleeve - 14 stages	=>	2-166441390 (168601640 - anello unione non incl. / connecting ring not incl.											
5	Filtro	Strainer	1	164600730											
* 6	Diffusore destro	Right diffuser	=>	152801240											
7	Coperchio diffusore	Diffuser cover	=>	1	2	3	4	5	4	5	6				
8	Kit cuscinetto N-B 8-11-14 stadi	Bearing kit N-B 8-11-14 stages	=>	Q2 - 164001740				Q3 - 164001740							
	B	B	=>	148992210											
			=>	2/2/3											
9	Distanziale diffusori	Diffuser spacer	Q	162502310											
* 10	Girante destra	Right impeller	R	150702260											
				1	2	3	4	5	4	5	6				
11	Distanziale finale	Final spacer	1	162502290											
12	Distanziale girante	Impeller spacer	=>	162502430											
				1	2	3	4	5	9	10	11				
13	Albero N-B 8-11-14 stadi	Shaft N-B 8-11-14 stages	1	165042560 / 165042570 / 165042575											
	Albero B 13-16 stadi	Shaft B 13-16 stages													
14	Protezione giunto	Coupling guard	2	164206580	164206590				165042530 / 165042580						
15	Kit semigiunti	Pair of couplings kit	1	148992390	148992400				148992410						
* 16	Tenuta meccanica	Mechanical seal	1	002232570											
17	Tirante	Tie rod	4												
	Dado M16	Nut M16													
18	Distanziale sostit. girante	Spacer replacing impeller	Q1	162502460											
19	Tappo carico (+ OR)	Fill plug (+ OR)	1												
* 20	Kit blocc. pacco giranti	Fixing impeller pack kit	1	148992160											
* 22	OR	OR	- 2												
* 23	Diffusore sinistro	Left diffuser	=>												
* 24	Girante sinistra	Left impeller	L												
25	Flangia per raccordo	Flange for connection	1					161050590							
26	Camicia superiore	Higher sleeve	1												
27	Tirante + dado M12	Tie rod + nut M12	4+4	167103430 + 002630710											
				167103460 + 002630710											
				167103470 + 002630710											
28	Motore trifase (T)	Three phase motor (T)	1	50002RF00	50013VE00	50017VB00	50019VE00	50024VB00	50025VB00	50026VE00					
	Tipo PLM	Type PLM		100RB14/330	132RB5/355	132B5/375	160RB5/3110	160B5/3150	160B5/3185	180RB5/3220					
** 29	Supporto boccola sald. N-B 8-11-14 stadi	Bushing support N-B 8-11-14 stages	=>	151402690											
	B	B	=>	1/1/2											
			=>												
** 30	Distanziale per supp. spec N-B 8-11-14 stadi	Spacer for special support N-B 8-11-14 stages	=>	162502760											
	B	B	=>	2/2/3											
			=>												

* Parti di ricambio consigliate - Recommended spare parts

Q = N. stadi / stages

Q1 = Q - (L+R) - 2 ; Per N-B / For N-B => 14 stadi/stages, Q1 = Q - (L+R) - 4

Q2 = Q - (L+R) ; Per N-B / For N-B => 14 stadi/stages, Q1 = Q - (L+R) - 1

Q3 = Q - (L+R) + 1, Per B / For B

** Solo Versioni Speciali - Only Special Versions

B = Bilanciate / Balanced, N - B = Non Bilanciate / Not Balanced